

## Technical Data

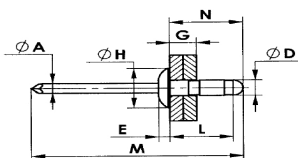

NOM. SIZE	ORNT CODE	IDENTIFICATION	LENGTH L +0.016 -0.008	G GRIP min-max	M ± 0.079	N	ØA ± 0.001	ØD ± 0.004	E ± 0.004	ØH ±0.01
1/8"	UN32068D	DOME-0408	0.268	0.134	1.575	0.331 ± 0.028	0.071	0.125	0.037	0.252
	UN32080D	DOME-0410	0.315	0.189	1.575	0.378 ± 0.028				
	UN32095D	DOME-0412	0.374	0.252	1.732	0.437 ± 0.028				
	UN32111D	DOME-0414	0.437	0.157 - 0.311	1.732	0.500 ± 0.028				
	UN32127D	DOME-0416	0.500	0.374	1.732	0.563 ± 0.028				
5/32"	UN40068D	DOME-0508	0.268	0.126	1.732	0.343 ± 0.024	0.089 OR 0.083	0.156	0.047	0.311
	UN40095D	DOME-0512	0.374	0.252	1.732	0.453 ± 0.024				
	*UN40111D	DOME-0514	0.437	0.126 - 0.311	1.850	0.516 ± 0.024				
	UN40127D	DOME-0516	0.500	0.157 - 0.374	1.850	0.579 ± 0.024				
	*UN40151D	DOME-0519	0.594	0.437	2.047	0.673 ± 0.024				
	**UN40169D	DOME-0521	0.665	0.500	2.047	0.744 ± 0.024				
3/16"	UN48103D	DOME-0613	0.406	0.252	1.850	0.504 ± 0.028	0.110	0.189	0.057	0.386
	UN48151D	DOME-0619	0.594	0.437	2.047	0.693 ± 0.028				
	UN48169D	DOME-0621	0.665	0.500	2.047	0.780 ± 0.051				
	UN48248D	DOME-0631	0.976	0.780	2.362	1.067 ± 0.035				

RIVET BODY MATERIAL	ALUM. ALLOY ALMG2.0/ALMG2.5-5251/5052 (DIN 1725)
MANDREL MATERIAL	STAINLESS STEEL AISI 430/434 OR EQUIVALENT
RIVET FINISH	BRIGHT FINISHED SURFACE
MANDREL FINISH	UNCOATED

RIVET SIZE	RECOMMENDED D DRILL	RECOMMENDED HOLE SIZE	TYPICAL SHEAR STRENGTH, kgf/Lbs	TYPICAL TENSILE STRENGTH, kgf/Lbs
1/8"	# 30/0.130	0.129 - 0.133	75 / 165	104 / 230
5/32"	# 20/0.161	0.161 - 0.165	116 / 255	170 / 375
3/16"	# 11/0.193	0.193 - 0.197	159 / 350	240 / 530
		UN40169D	106 / 235	